

4

3

2

1

REVISIONS		
A	RELEASED FOR REVIEW	10/12/20
B	FASTENERS ADDED, WEIGHT REVISED	12/12/20

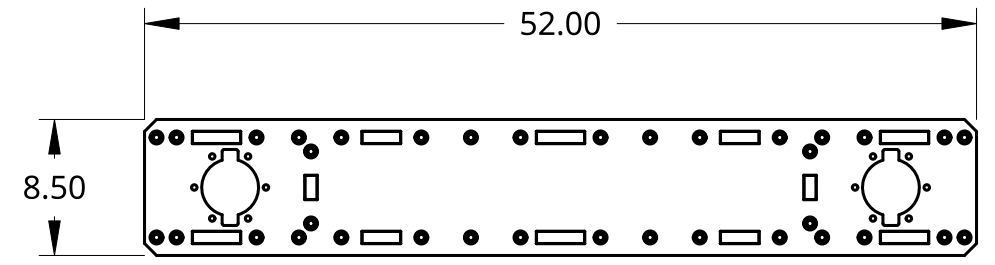
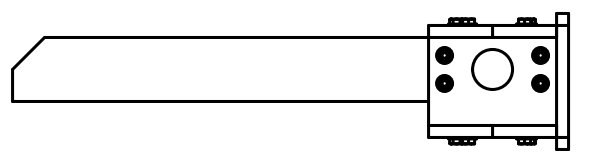
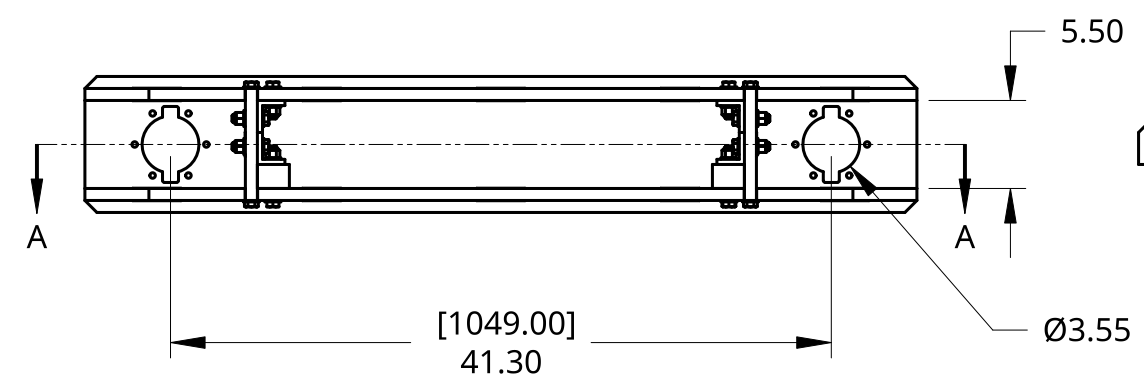
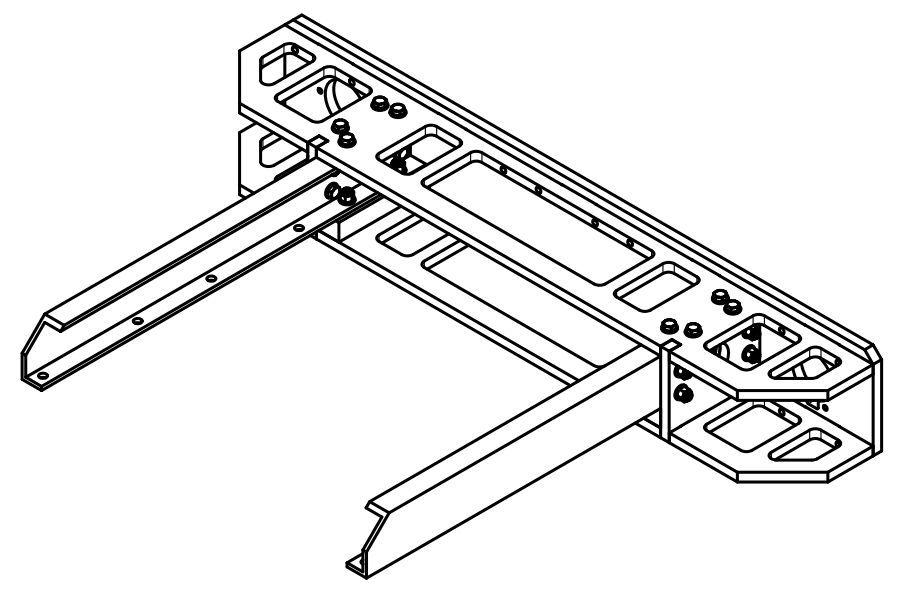
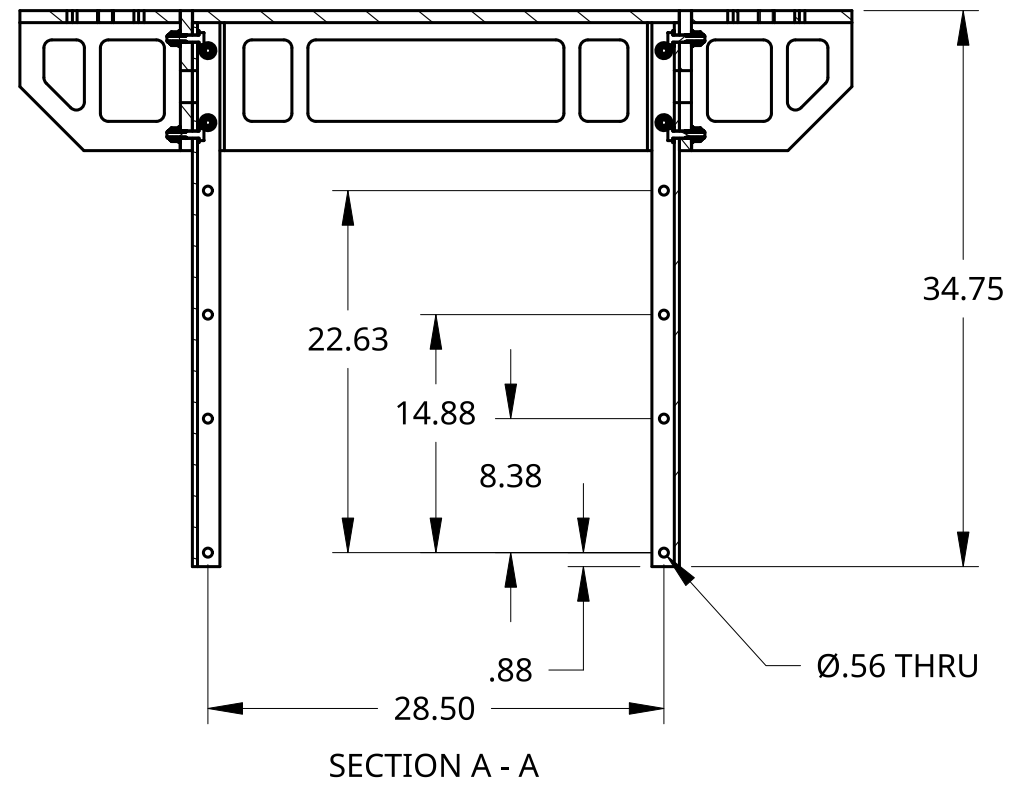

- NOTE:
1. APPROX 98 LBS IN AIR (NOT INCLUDING PROBES)
  2. APPROX 70 LBS IN SEAWATER

UNLESS OTHERWISE SPECIFIED,  
DIMENSIONS ARE IN INCHES

.XX = ±.0-  
.XXX = ±.00-  
.XXXX = ±.000-

ANGULAR = ± °  
FRACTIONAL = ±

SURFACE FINISH

DO NOT SCALE DRAWING

BREAK ALL SHARP EDGES AND REMOVE BURRS

THIRD ANGLE PROJECTION

	NAME	DATE
DRAWN	RANDY LEWKOSKI	12/08/2020
CHECKED		
APPROVED		

TITLE		
ISO DOCKING BEAM ASSEMBLY		
SIZE	DWG NO.	REV.
B	CTI-TFMC-201208-8001	B
SCALE	WEIGHT	SHEET
1:12		1 of 2

4

3

2

1

D

D

C

C

B

B

A

A

4

3

2

1

D

D

C

C

B

B

A

A

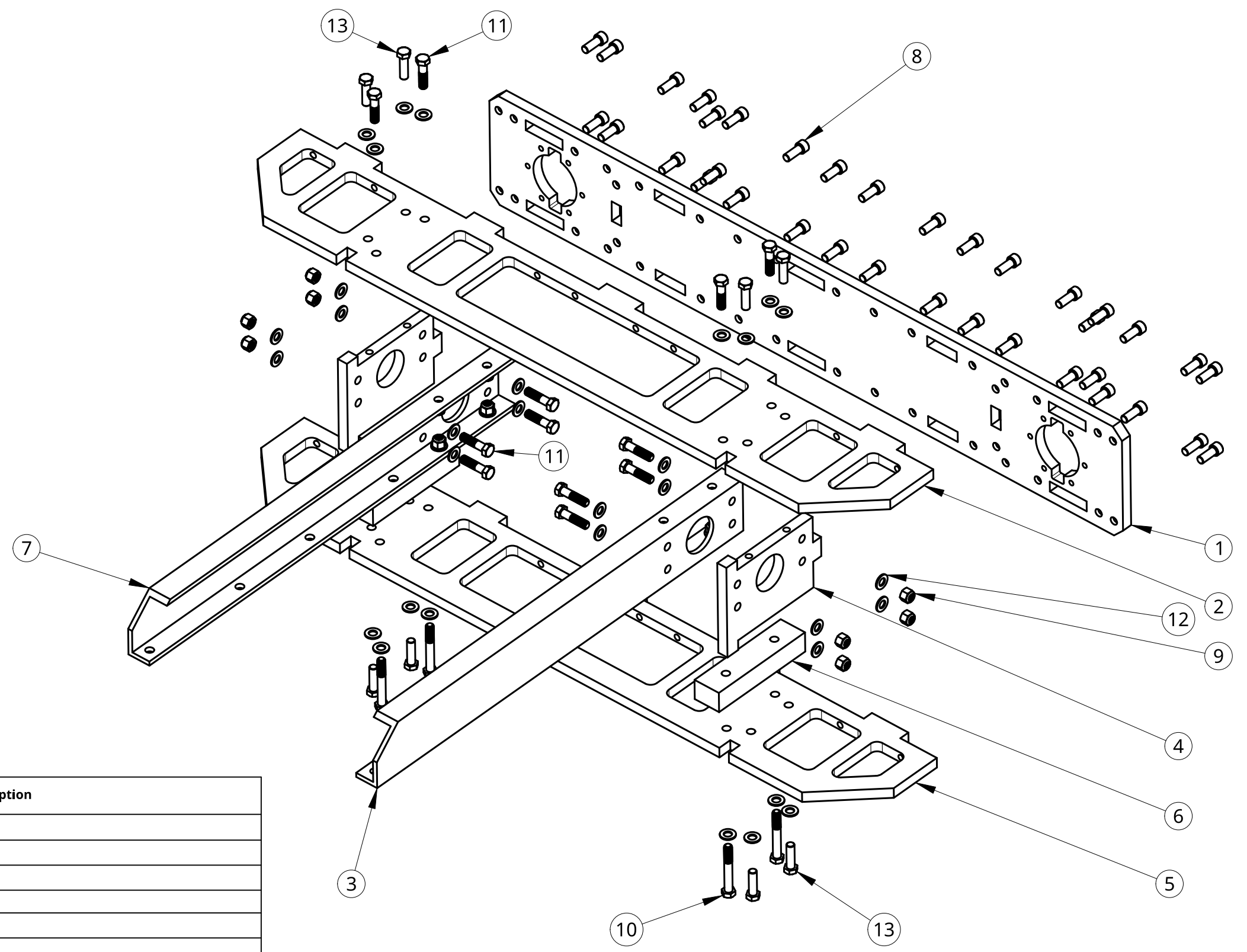

NOTE:  
 1. ITEMS #2 AND #5 ARE IDENTICAL  
 2. ITEMS #3 AND #7 ARE SYMMETRICAL

Item	Quantity	Part number	Description
1	1	CTI-TFMC-201208-0001	FRONT PLATE
2	1	CTI-TFMC-201208-0003	BOTTOM PLATE
3	1	CTI-TFMC-201208-0007	PORT BRACKET
4	2	CTI-TFMC-201208-0004	SPACER
5	1	CTI-TFMC-201208-0002	TOP PLATE
6	2	CTI-TFMC-201208-0005	WEDGE
7	1	CTI-TFMC-201208-0006	STBD BRACKET
8	36	92185A714	Super-Corrosion-Resistant 316 Stainless Steel Socket Head Screw, 1/2"-13 Thread Size, 1-1/4" Long
9	16	90715A165	316 Stainless Steel Nylon-Insert Locknut, Super-Corrosion-Resistant, 1/2"-13 Thread Size
10	4	92186A726	Super-Corrosion-Resistant 316 Stainless Steel Hex Head Screw, 1/2"-13 Thread Size, 3-1/2" Long, Partially Threaded
11	12	92186A720	Super-Corrosion-Resistant 316 Stainless Steel Hex Head Screw, 1/2"-13 Thread Size, 2" Long, Partially Threaded
12	40	91525A334	316 Stainless Steel Washer, Oversized, 1/2" Screw Size, 0.531" ID, 1" OD
13	8	93190A718	Super-Corrosion-Resistant 316 Stainless Steel Hex Head Screw, 1/2"-13 Thread Size, 1-3/4" Long

SCALE 1:7

4

3

2

1